

PERMIT MUST BE  
POSTED AT THE  
CONSTRUCTION SITE



171279000  
Detroit Lakes, MN 56502-0787  
Phone (218)-846-7314; Fax (218)-846-7266

17.1279.000  
17.0074.000

Onsite Septic System Site Evaluation/Design

Legal Description: Lot 33 TRADEWINDS BRACH Section 7 TWP 138 Range 42

Lake Name CORMORANT Lake Classification RD Township Name LAKF EUNICP

Owner's Name Gregg Johnson Address 443 CLEARVIEW COURT

City MURHEAD MN State/Zip 56560 Phone Number 236-0347

Number of Bedrooms 3 Well Casing Depth 7.50' Garbage Disposal (Yes) (No)

Design Flow 450 GPD Depth of other Wells within 100 ft of system 7.50' Grinder Pump/Lift Station In House (Yes) (No)

Type of Observation: Probe Pit Boring Original Soil (Yes) (No) Compacted Soil (Yes) (No)

Depth to Restricting Layer 7.60 Proposed Design (X) Septic Tank/Drainfield Type of Drainfield (X) Standard (gravelless chamber)

Maximum of Depth of System 29" ( ) Drainfield Only ( ) Standard (rock depth)

Perc Rate 11 Soil Sizing Factor 1.27 ( ) Holding Tank ( ) Standard Bed

(X) Lift Station ( ) Mound ( ) At Grade

( ) Pressurized Bed

SOIL BORING LOG

DEPTH (INCHES)	TEXTURE	COLOR & MUNSSELL NO.	STRUCTURE
0-7	SANDY LOAM	10YR 2/2 V.D. BROWN	BLOCKY PLATY PRISMATIC NONE
7-11	LOAM	10YR 5/4 Y.D. BROWN	BLOCKY PLATY PRISMATIC NONE
11-60	LOAM	10YR 6/6 BROWN, Y.D.	BLOCKY PLATY PRISMATIC NONE
			BLOCKY PLATY PRISMATIC NONE

SOIL BORING LOG

DEPTH (INCHES)	TEXTURE	COLOR & MUNSSELL NO.	STRUCTURE
0-11	SANDY LOAM	10YR 2/2 V.D. BROWN	BLOCKY PLATY PRISMATIC NONE
11-16	LOAM	10YR 5/4 Y.D. BROWN	BLOCKY PLATY PRISMATIC NONE
16-60	LOAM	10YR 6/6 BROWN, Y.D.	BLOCKY PLATY PRISMATIC NONE
			BLOCKY PLATY PRISMATIC NONE

Attach Perc Test Information If Required

Name and Address of Designer Grant Olson Audubon MN Phone 439-6428

MPCA Number 932 Date of Site Evaluation 5-24-99 Signature of Designer Grant Olson

Name of Installer (if different from Designer) \_\_\_\_\_ MPCA Number \_\_\_\_\_

**\*FOR USE BY BECKER COUNTY ENVIRONMENTAL SERVICES DEPARTMENT ONLY\***

\*\*\* Any changes to the permit must first be approved by Becker County Planning & Zoning. No system shall be covered up without inspection by Becker County Planning & Zoning.

\*\*\* Inspections must be scheduled at least 24 hours prior to time requested.

Date Received 10.5.99 Application Fee 75.00 State Surcharge 50 Total 75.50

[ ] Application is hereby denied  
[X] Application is hereby granted to Gregg Johnson to install an individual septic system according to the specifications of the site evaluation and design submitted to the Becker County Environmental Services Office. By Order of: [Signature]

Signature of Becker County Qualified Employee [Signature] Date Permit Issued 10.5.99 Permit Number \_\_\_\_\_

This permit expires on 10 Dec 99

The site plan must be drawn to dimension or to scale:

- \*Dimensions of Lot
  - \*Well & Water Line Locations within 100 ft of System
- \*Existing & Proposed Buildings
  - \*Distance from Property Lines
  - \*Distance from OHWM
- \*Easements & setbacks
  - \*Tank Access Route
  - \*Distance from buildings
- \*Scale - One inch = \_\_\_\_\_ ft
  - \*Location of any Unsuitable Soil
  - \*Soil Borings & Per Test Locations
  - \*Alternate Drainfield Location

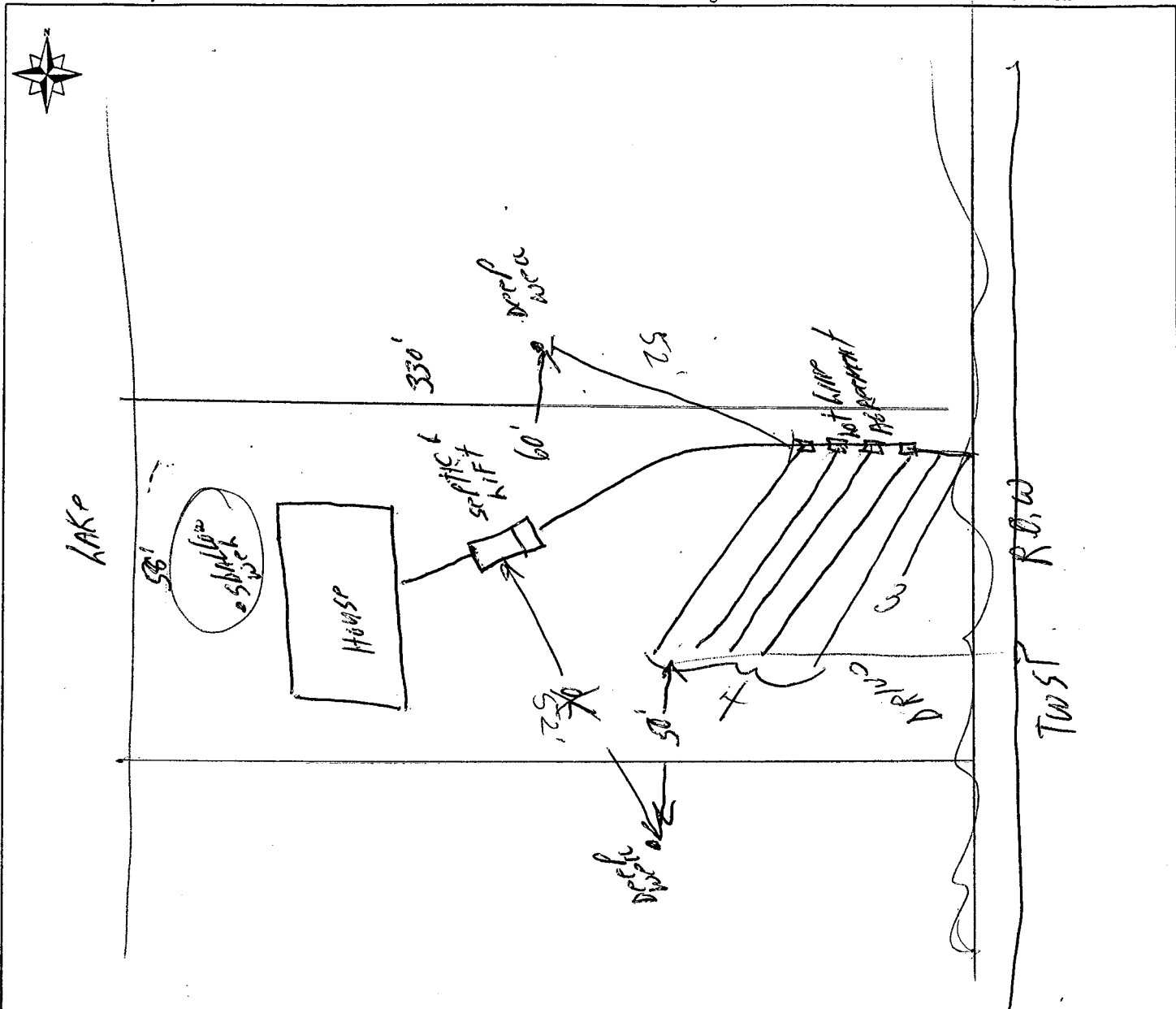

	Tank (estimated)	Tank (actual)	Drainfield (estimated)	Drainfield (actual)
Distances to Well	50	52' (neighbor)	30	52'
Distance to Building	20	18'	25	52' (neighbor) 20'
Distance to Property Line	20	10'	10	110'
Distance to Pressure Line				
Distance to Ordinary High Water	85	100'	125	125'

Tank size 1000  
 Lift station size 500  
 Drainfield size 575  
 Pump HP 1/2 hp  
 Date Installed 10/30/00

**\*FOR USE BY BECKER COUNTY ENVIRONMENTAL SERVICES DEPARTMENT ONLY\***

### CERTIFICATE OF COMPLIANCE

( ) Certificate Is Hereby Denied

(X) Certificate is Hereby Granted Based upon the Application, addendum from, plans, specifications and all other supporting data. With property maintenance, this system can be expected to function satisfactory, however, this is not a guarantee.

Signature Nancy Young Title Zoning Inspector Date 10/30/08  
 (Certificate of Compliance is not valid unless signed by a Registered Qualified Employee)

PERMIT MUST BE POSTED AT JOB SITE, VISIBLE FROM ROAD

BECKER COUNTY PLANNING & ZONING

835 LAKE AVENUE, PO BOX 787  
DETROIT LAKES, MN 56502-0787  
PHONE (218) 846-7314 - FAX (218) 846-7266

BUILDING PERMIT APPLICATION/PERMIT

FIRE NO. 5071

RECEIPT NO. 13396

TAX PARCEL NUMBER 17.1279.00

LEGAL DESCRIPTION

Lot 33 Trade Winds Beach Big CORMORANT LAKE

LAKE/STREAM NAME

LK/STR CLASS

SECTION

TWP

RANGE

TOWNSHIP NAME

Big CORMORANT

7 / 39 42

PROPERTY OWNER

ADDRESS

PHONE NO

GREGORY AND Shirley JOHNSON 443 Clearview Court Moorhead MN 218-236-0347

CONTRACTOR

LICENSE NO

PHONE NO

Don Engrebretson Construction

761-261-0469

Type of Project

Structure Type

Type of Construction

Type of Sewer System

( ) New Construction

(☒) Residence

(☒) Wood Frame

(☒) Tank & Drainfield

(☒) Addition

( ) Garage

( ) Masonry

( ) Holding Tank

( ) Relocation

( ) Storage

( ) Metal

( ) Other (specify)

( ) Repair

( ) Other (specify)

( ) Pole Building

( ) Other

Date of Installation

Well Depth

1999-Ohn

Brief description of the work to be done:

Width

Length

Height

Replace deck on <sup>8'</sup> front (West - Lakeside of Cabin)

Construct Covered Porch 10'

Lot Dimensional Data

Setbacks From:

Area in Sq Ft

Lot width at Bldg Line 55

Lot Depth 330

Land Height above High Water Mark  
at the Building Line 30-40'

Lake/Stream

Side Lot Line

Rear Lot Line

TWP Road (cl)

County Road (cl)

State Road (ROW)

64' \*

7' (South) 18'6" (N)

233'

233'

\* no closer to lake than existing structure

On back, please draw a site plan showing the above information.

Please draw a site plan showing the distances furnished on the front of the application.

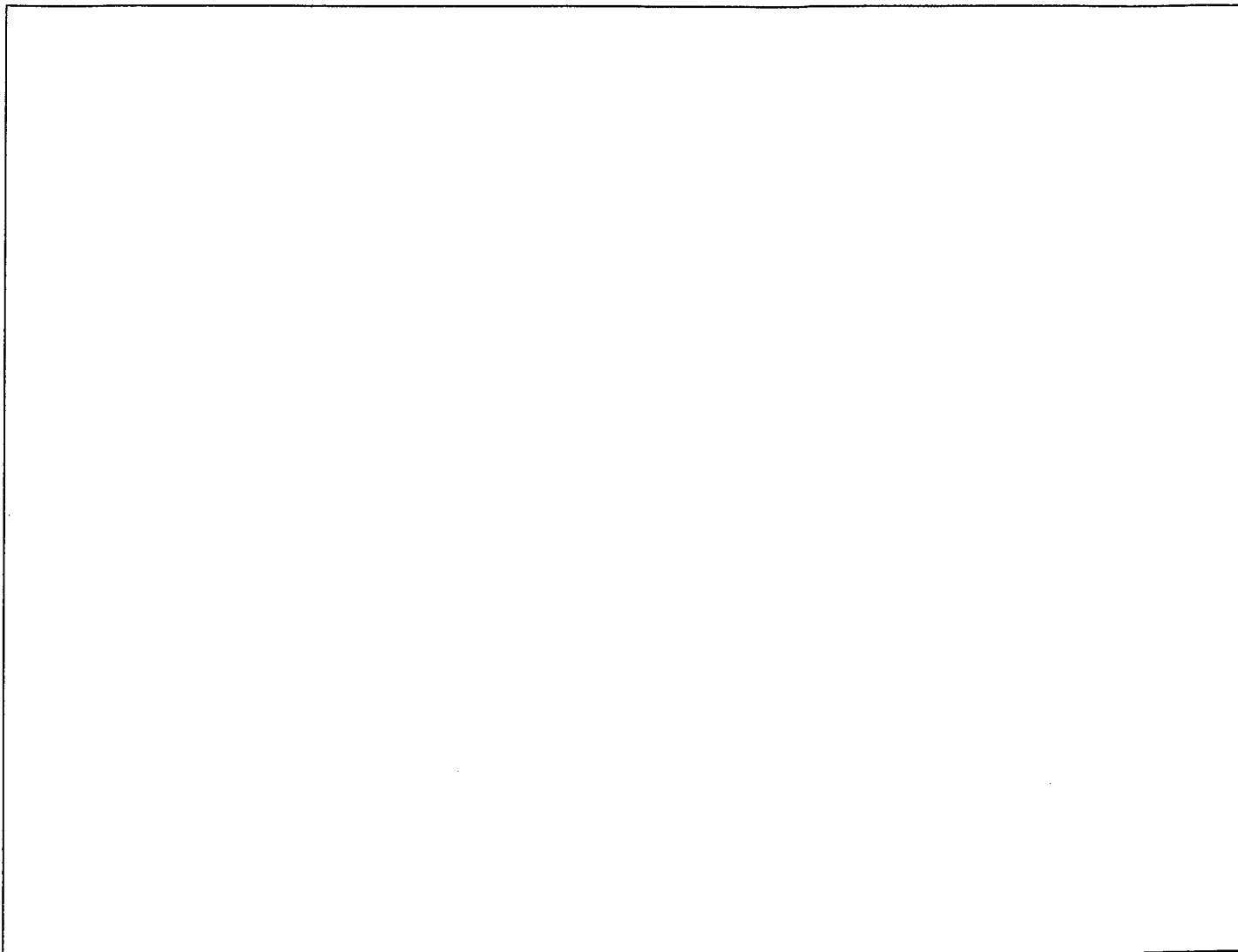

I hereby certify with my signature that all data contained herein as well as all supporting data are true and correct to the best of my knowledge. I also understand that this permit is valid for a period of six (6) months, with a six (6) month extension if footings are in place.

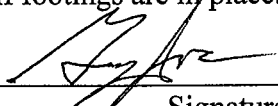
 Date 5/24/99  
Signature

For Office Use Only

Application Fee 75<sup>00</sup> Cormorant Surcharge — Total 75<sup>00</sup>

☐ Application is hereby denied

☒ Application is hereby granted to D. Johnson to replace deck & construct porch  
all in accordance with the application, addendum form, plans, specifications and all other supporting data. By order of:

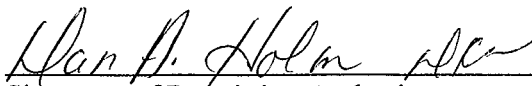
 Becker County Zoning 6/2/99  
Signature of Permitting Authority Date  
This Permit expires on 12/2/99



# BECKER COUNTY

829 LAKE AVENUE, P.O. BOX 787  
DETROIT LAKES, MINNESOTA 56502-0787  
(218) 848-7314

## SKETCH PLAN FORM H

Fire No.

Application No.

Tax Parcel No.

Please be as complete as possible. Include all of the items listed below where applicable.

### GENERAL CHECKLIST

- ☐ scale
- ☐ north arrow
- ☐ lot dimensions
- ☐ structure location
- ☐ side lot setback
- ☐ road setback
- ☐ septic tank location
- ☐ drainfield location
- ☐ location of all wells within 100' of drainfield
- ☐ fill & grading limits
- ☐ vegetation alteration limits

### WATER RESOURCE CHECKLIST

- ☐ location of ordinary high water level (OHWL)
- ☐ location of present water line
- ☐ setback from OHWL
- ☐ location of highest known water level
- ☐ existing local drainage
- ☐ location of wetland areas

Scale of Diagram: 1 inch = \_\_\_\_\_ feet

Drawing By: \_\_\_\_\_

Date of Drawing: \_\_\_\_\_

Remarks: \_\_\_\_\_

Signature \_\_\_\_\_

EXISTING front porch is 8' towards LAKE and 14'6" ACROSS.

← NORTH

